

# Nevolat<sup>®</sup> (liraglutide)

## Step-by-Step Guide

This guide will help you use your Nevolat<sup>®</sup> Pen. Always use this medicine exactly as your doctor has told you and contact your doctor, pharmacist, or nurse if you have any questions.

There are four simple steps to using your Nevolat<sup>®</sup> Pen:

**Prep**

**Flow**

**Dose**

**Go**

### 1. Prepare your pen with a new needle

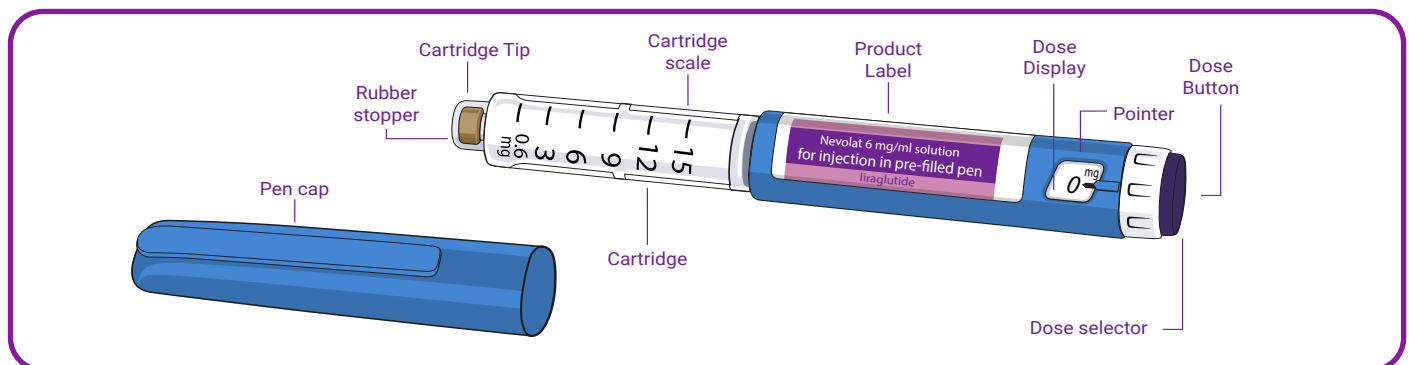

Check the name and coloured label of the pen to ensure it contains liraglutide. Once checked, pull off the pen cap.

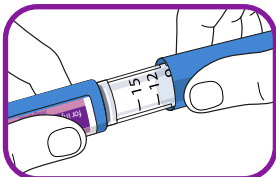

Check that the solution in the pen is clear and colourless by looking through the pen window. Do not use the pen if the solution looks cloudy.

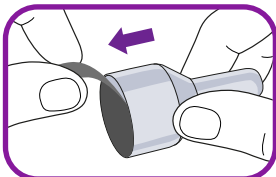

Remove the paper tab from a new disposable needle.

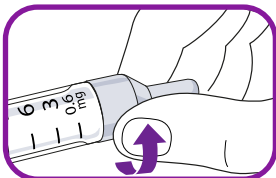

Screw the needle straight and tightly onto the pen.

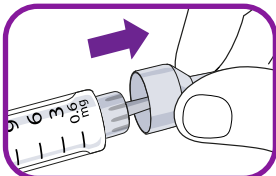

The needle is covered by two caps. Remove the outer needle cap and place on a clean surface for later.

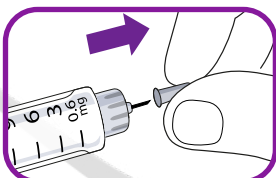

Pull off the inner needle cap and throw it away.



## 2. Check the flow

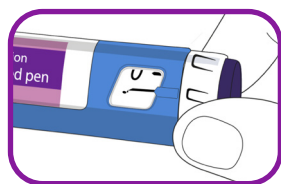

Check the flow with each new pen prior to your first injection with it. Turn the dose selector until the flow check symbols line with the pointer.

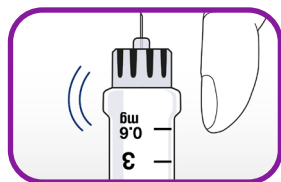

Hold the pen with the needle pointing up. Tap the cartridge gently with your finger a few times. This will make any air bubbles collect at the top of the cartridge.

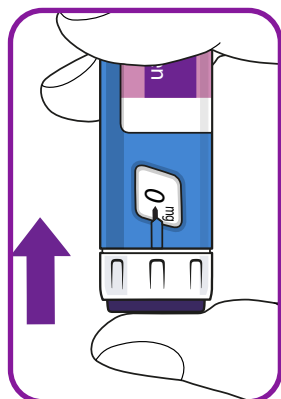

Keep the needle pointed up and press the dose button until the 0mg lines up with the pointer. A drop of medicine should appear at the needle tip.

If no drop appears, repeat "Check the Flow" up to four times. If there is still no drop of medicine appearing, you should change the needle and repeat "Check the Flow" steps.

Do not use the pen if a drop still does not appear as it indicates the pen is defective and you should use a new one.

## 3. Selecting your dose

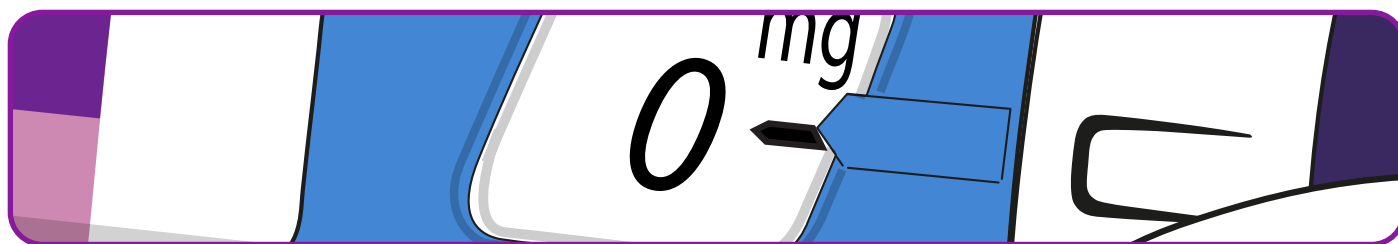

Before you begin, always check that the pointer lines up with the 0mg.

Turn the dose selector until your required dose lines up with the pointer (0.6mg, 1.2 mg, 1.8 mg, 2.4 mg or 3.0 mg). If you have selected the wrong dose, you can change it by simply turning the dose selector forwards or backwards until the right dose lines up with the pointer, taking care not to press the dose button as medicine may come out.

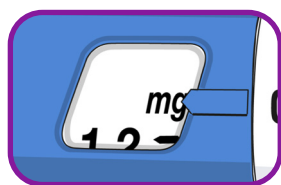

If the dose selector stops before the required dose lines up with the pointer, there is not enough medicine left for a full dose. You can either prepare a new full pen for injection or, if advised by your doctor or nurse, split your doses between the current pen and a new pen.

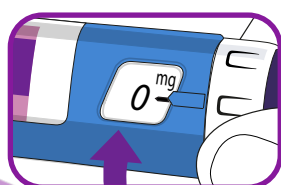

Turn the dose selector in either direction until 0.6mg or 1.2mg lines up with the pointer, inject the dose, then prepare a new pen and inject the rest of the dose needed. A calculator may help you to plan the doses.

**Inject the full dose with a new pen:** If the dose selector stops before 0.6 mg lines up with the pointer, prepare a new pen and inject the full dose with the new pen.

## 4. Go - Injecting your medication

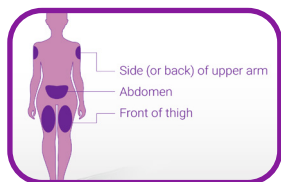

Be careful not to touch the display or turn the dose selector sideways when you inject, as this might interrupt the injection. Insert the needle into the skin, as shown by your doctor or nurse. Press and hold down the dose button until the dose counter shows 0. The 0 must line up with the dose pointer. You may then hear or feel a click.

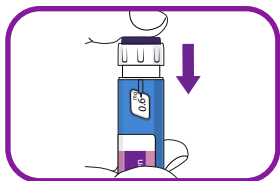

Keep the dose button pressed down and leave the needle under the skin for **at least 6 seconds** to make sure you get the full dose.

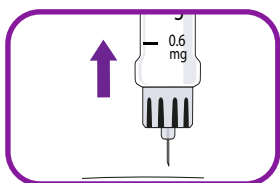

Pull out the needle. You may see a drop of medicine at the needle tip. This is normal and does not affect your dose.

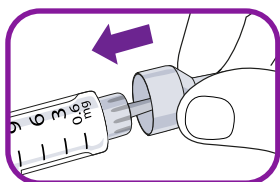

You should guide the needle tip into the outer needle cap without touching the needle or the outer needle cap.

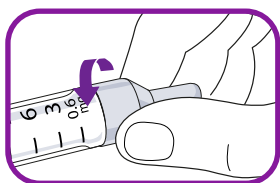

When the needle is covered, carefully push the outer needle cap completely on. Then unscrew the needle and dispose of it carefully in your sharps bin.

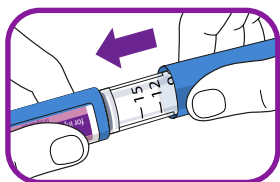

The pen cap can then be replaced.

When the pen is empty, you should carefully dispose of it without a needle attached, in accordance with local requirements.



Please scan this QR code to watch our "How to use the Nevolat<sup>®</sup> pen" video. This will help ensure you're using your Nevolat<sup>®</sup> pen correctly.



Always use this medicine exactly as your doctor has told you. Check with your doctor, pharmacist or nurse if you have any questions about taking Nevolat<sup>®</sup>.  
Date of preparation: April 2025.  
Reference: 000745543

Adverse events should be reported. Reporting forms and information can be found at [www.mhra.gov.uk/yellowcard](http://www.mhra.gov.uk/yellowcard). Adverse events should also be reported to Zentiva via email to [UKmedinfo@zentiva.com](mailto:UKmedinfo@zentiva.com) or via phone on 0800 090 2408.